

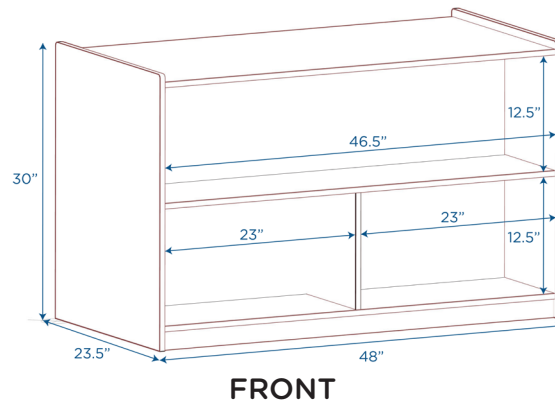

Double-Sided Storage

Double-Sided wooden storage with 3 separate storage compartments on each side

MODEL #: ANG1228



FRONT

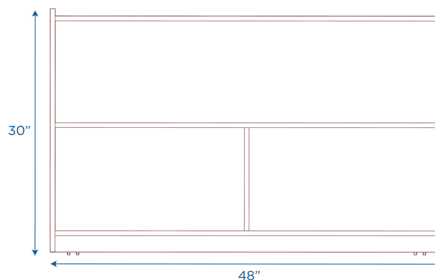

BACK

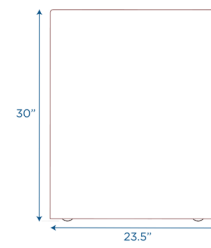

SIDE

OVERVIEW:

Unit ships fully assembled. Unit features identical storage areas on each side plus easy-roll casters. Large storage areas measure 46-1/2"l x 12-1/2"h, and small storage areas measure 23"l x 12-1/2"h.

MATERIALS:

This storage unit is constructed from strong, 11-ply 5/8" thick birch veneer panels with a tough water-based clear UV that is extremely scratch-, dent- and stain-resistant. Unit features kick plates and rounded corners for safety.

Digital Swatches:



Model #	Description	L"	W"	H"	WT lbs.	Cube	FC	Truck Only
ANG1228	Double-Sided Storage	48	23.5	30	90			Y
	Shipping Dimensions	50	26	33	97	24.83	250	

ADDITIONAL INFORMATION:

AGE RATING: General Use

STANDARDS AND TEST COMPLIANCE: N/A

GREENGUARD GOLD CERTIFIED: Yes

WARRANTY: Limited Lifetime

KEYWORDS: storage shelves; storage shelf; nursery furniture; classroom organization; classroom; preschool; daycare furniture; kids storage organizer; cubby shelving; cubby storage shelf; shoe cubby; kids organizers and storage; kids toy storage; kids toy storage organizer; classroom storage; daycare furniture; cubbies storage for kids; kids cubby; toy storage for toddlers; nursery storage; cubbies storage shelves; classroom shelves; teacher organization for classroom; classroom organization and storage for teachers; teacher organizers and storage